

Metal Carport 62' - 100'

Certified for 150 mph and 30 psf

Prices subject to change without notice

Sample Starting Base Prices

Width	20' Long	40' Long	52' Long
62' Wide	\$19,795	\$27,795	\$32,795
70' Wide	\$22,895	\$30,895	\$35,895
80' Wide	\$26,695	\$34,725	\$40,695
90' Wide	\$30,595	\$38,595	\$45,095
100' Wide	\$34,495	\$42,495	\$49,495

See the full pricing guide for more sizes and options.



1-Year Workmanship Warranty
(Limited)



20-Year Limited Rust-Through Warranty
Vertical Roof Panels only
(up to any length)



20-Year Rust-Through Warranty
on 12-Gauge, 2 1/4" Tubing

All buildings include:

- 26-Gauge Sheet Metal
- Anchors included
- 12-Gauge Framing

- Custom site specific engineering plans available for an additional cost (5% of building cost, max of \$6,500).
- Freight fees will apply to purchase -3% of pre-tax price.

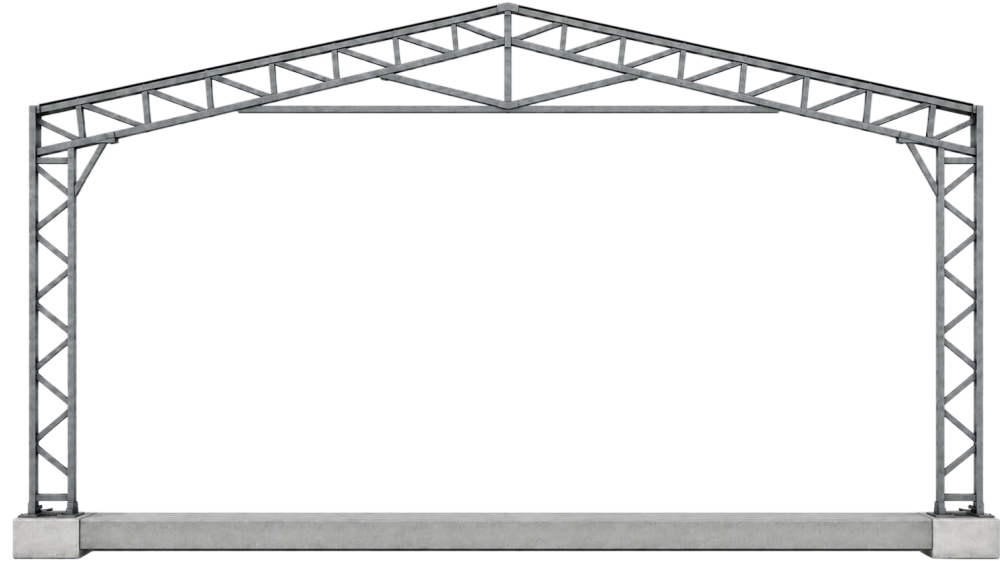

Lattice Legs + Engineered Roof Trusses

Extra-wide buildings use a different frame system to support larger widths.

Free color selection for roof, trim, and siding (if selected)

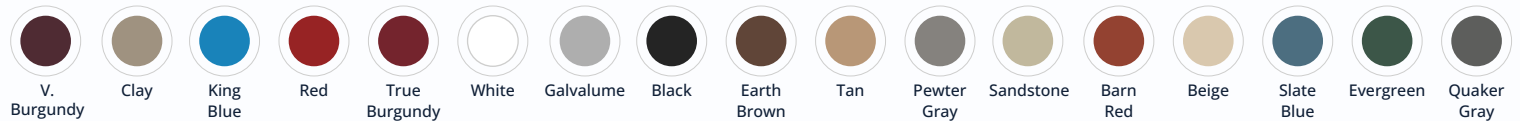

- Footing requirements vary by local codes. Check before installation.
- Lot must be cleared and leveled prior to installation.
- Price does not include site preparation.



Fast Delivery & installation
to save you money

We accept all
major credit cards

1 Year
Workmanship Warranty

All prices are subject to change without notice.

1-800-488-6903

alansfactoryoutlet.com

Metal Carport Prices

62'-70' Wide Buildings					
Length	62' W	64' W	66' W	68' W	70' W
20'	\$19,795	\$20,595	\$21,295	\$22,095	\$22,895
24'	\$21,395	\$22,095	\$22,895	\$23,695	\$24,495
28'	\$22,995	\$23,695	\$24,495	\$25,295	\$25,995
32'	\$24,795	\$25,495	\$26,295	\$27,095	\$27,795
36'	\$26,195	\$26,995	\$27,795	\$28,495	\$29,295
40'	\$27,795	\$28,595	\$29,395	\$30,095	\$30,895
44'	\$29,395	\$30,195	\$30,895	\$31,695	\$32,495
48'	\$30,995	\$31,795	\$32,495	\$33,295	\$34,095
52'	\$32,795	\$33,495	\$34,295	\$35,095	\$35,895
56'	\$44,990	\$47,390	\$48,990	\$50,590	\$51,990
60'	\$47,790	\$49,190	\$50,790	\$52,390	\$53,790
80'	\$55,590	—	—	—	—
100'	\$63,790	—	—	—	\$69,990
120'	\$83,385	—	—	—	\$92,685
150'	—	—	—	—	\$105,885

72'-80' Wide Buildings					
Length	72' W	74' W	76' W	78' W	80' W
20'	\$23,695	\$24,395	\$25,195	\$25,995	\$26,695
24'	\$25,195	\$25,995	\$26,795	\$27,495	\$28,295
28'	\$26,795	\$29,995	\$28,295	\$29,095	\$29,895
32'	\$29,195	\$27,595	\$30,895	\$31,795	\$32,695
36'	\$30,095	\$30,895	\$31,595	\$32,395	\$33,195
40'	\$31,695	\$32,395	\$33,195	\$33,995	\$34,725
44'	\$33,195	\$33,995	\$34,795	\$35,959	\$36,295
48'	\$34,795	\$35,595	\$36,295	\$37,095	\$37,895
52'	\$37,195	\$37,995	\$38,895	\$39,795	\$40,695
56'	\$53,590	\$55,190	\$56,590	\$58,190	\$59,790
60'	\$55,990	\$30,590	\$59,190	\$60,890	\$62,590
80'	—	—	—	—	\$69,450
100'	—	—	—	—	\$78,590
120'	—	—	—	—	\$104,175
150'	—	—	—	—	\$119,285
200'	—	—	—	—	\$157,180

82'-90' Wide Buildings					
Length	82' W	84' W	86' W	88' W	90' W
20'	\$27,495	\$28,295	\$29,095	\$29,795	\$30,595
24'	\$29,095	\$29,895	\$30,495	\$31,395	\$32,195
28'	\$30,695	\$31,395	\$32,195	\$32,995	\$33,795
32'	\$33,595	\$32,295	\$33,895	\$34,595	\$35,395
36'	\$34,595	\$34,695	\$35,495	\$36,195	\$36,995
40'	\$35,495	\$36,295	\$37,095	\$39,395	\$38,595
44'	\$37,095	\$37,895	\$38,595	\$37,795	\$40,195
48'	\$38,695	\$39,395	\$40,195	\$40,995	\$41,795
52'	\$41,595	\$42,495	\$43,295	\$44,195	\$45,095
56'	\$61,390	\$62,790	\$64,390	\$65,990	\$67,590
60'	\$64,290	\$63,690	\$66,090	\$67,590	\$69,190
80'	—	—	—	—	\$77,190
100'	—	—	—	—	\$86,890
120'	—	—	—	—	\$115,785
150'	—	—	—	—	\$131,985
200'	—	—	—	—	\$173,780

92'-100' Wide Buildings					
Length	92' W	94' W	96' W	98' W	100' W
20'	\$31,395	\$32,095	\$32,895	\$33,695	\$34,495
24'	\$32,895	\$33,695	\$34,495	\$35,195	\$35,995
28'	\$34,495	\$35,295	\$35,095	\$36,795	\$37,595
32'	\$36,095	\$36,995	\$37,195	\$38,495	\$39,295
36'	\$37,795	\$38,595	\$39,295	\$40,095	\$40,895
40'	\$39,395	\$40,095	\$40,895	\$41,695	\$42,495
44'	\$40,995	\$41,695	\$42,395	\$43,295	\$44,095
48'	\$42,495	\$43,295	\$44,095	\$44,795	\$45,595
52'	\$45,995	\$46,895	\$47,695	\$48,595	\$49,495
56'	\$68,990	\$70,590	\$70,190	\$73,590	\$75,190
60'	\$70,590	\$72,290	\$72,290	\$75,290	\$76,890
100'	—	—	—	—	\$95,090
120'	—	—	—	—	\$127,485
150'	—	—	—	—	\$144,585
200'	—	—	—	—	\$190,180
300'	—	—	—	—	\$285,270

*Prices shown are for 8' tall vertical roof.

Close Sides and Ends

Width	8' Tall		10' Tall		12' Tall		14' Tall		16' Tall		18' Tall		20' Tall		22' Tall		24' Tall	
	Close one End	Close Both Ends	Close one End	Close Both Ends	Close one End	Close Both Ends	Close one End	Close Both Ends	Close one End	Close Both Ends	Close one End	Close Both Ends	Close one End	Close Both Ends	Close one End	Close Both Ends	Close one End	Close Both Ends
62'	\$5,405	\$10,810	\$5,605	\$11,210	\$5,800	\$11,600	\$6,000	\$12,000	\$6,200	\$12,400	\$6,395	\$12,790	\$6,530	\$13,060	\$6,660	\$13,320	\$6,990	\$13,980
64'	\$5,540	\$11,080	\$5,735	\$11,470	\$5,935	\$11,870	\$6,135	\$12,270	\$6,330	\$12,660	\$6,530	\$13,060	\$6,730	\$13,460	\$6,925	\$13,850	\$7,120	\$14,240
66'	\$5,670	\$11,340	\$5,870	\$11,740	\$6,065	\$12,130	\$6,265	\$12,530	\$6,460	\$12,920	\$6,660	\$13,320	\$6,860	\$13,720	\$7,055	\$14,110	\$7,255	\$14,510
68'	\$5,800	\$11,600	\$6,000	\$12,000	\$6,200	\$12,400	\$6,400	\$12,800	\$6,595	\$13,190	\$6,795	\$13,590	\$6,995	\$13,990	\$7,190	\$14,380	\$7,386	\$14,772
70'	\$5,935	\$11,870	\$6,135	\$12,270	\$6,330	\$12,660	\$6,530	\$13,060	\$6,725	\$13,450	\$6,925	\$13,850	\$7,125	\$14,250	\$7,320	\$14,640	\$7,520	\$15,040
72'	\$6,065	\$12,130	\$6,265	\$12,530	\$6,465	\$12,930	\$6,660	\$13,320	\$6,860	\$13,720	\$7,055	\$14,110	\$7,255	\$14,510	\$7,455	\$14,910	\$7,650	\$15,300
74'	\$6,200	\$12,400	\$6,395	\$12,790	\$6,595	\$13,190	\$6,795	\$13,590	\$6,990	\$13,980	\$7,190	\$14,380	\$7,390	\$14,780	\$7,585	\$15,170	\$7,785	\$15,570
76'	\$6,330	\$12,660	\$6,530	\$13,060	\$6,725	\$13,450	\$6,925	\$13,850	\$7,125	\$14,250	\$7,320	\$14,640	\$7,520	\$15,040	\$7,720	\$15,440	\$7,915	\$15,830
78'	\$6,460	\$12,920	\$6,660	\$13,320	\$6,860	\$13,720	\$7,055	\$14,110	\$7,255	\$14,510	\$7,455	\$14,910	\$7,655	\$15,310	\$7,850	\$15,700	\$8,050	\$16,100
80'	\$6,595	\$13,190	\$6,795	\$13,590	\$6,990	\$13,980	\$7,190	\$14,380	\$7,385	\$14,770	\$7,585	\$15,170	\$7,785	\$15,570	\$7,980	\$15,960	\$8,180	\$16,360
82'	\$6,725	\$13,450	\$6,925	\$13,850	\$7,125	\$14,250	\$7,320	\$14,640	\$7,520	\$15,040	\$7,715	\$15,430	\$7,915	\$15,830	\$8,115	\$16,230	\$8,310	\$16,620
84'	\$6,860	\$13,720	\$7,055	\$14,110	\$7,255	\$14,510	\$7,455	\$14,910	\$7,650	\$15,300	\$7,850	\$15,700	\$8,050	\$16,100	\$8,245	\$16,490	\$8,445	\$16,890
86'	\$6,990	\$13,980	\$7,190	\$14,380	\$7,385	\$14,770	\$7,585	\$15,170	\$7,785	\$15,570	\$7,980	\$15,960	\$8,150	\$16,300	\$8,375	\$16,750	\$8,575	\$17,150
88'	\$7,125	\$14,250	\$7,320	\$14,640	\$7,520	\$15,040	\$7,720	\$15,440	\$7,915	\$15,830	\$8,110	\$16,220	\$8,350	\$16,700	\$8,510	\$17,020	\$8,705	\$17,410
90'	\$7,255	\$14,510	\$7,455	\$14,910	\$7,650	\$15,300	\$7,850	\$15,700	\$8,045	\$16,090	\$8,245	\$16,490	\$8,450	\$16,900	\$8,640	\$17,280	\$8,840	\$17,680
92'	\$7,385	\$14,770	\$7,585	\$15,170	\$7,785	\$15,570	\$7,980	\$15,960	\$8,190	\$16,380	\$8,375	\$16,750	\$8,565	\$17,130	\$8,775	\$17,550	\$8,970	\$17,940
94'	\$7,520	\$15,040	\$7,720	\$15,440	\$7,915	\$15,830	\$8,115	\$16,230	\$8,310	\$16,620	\$8,510	\$17,020	\$8,710	\$17,420	\$8,925	\$17,850	\$9,105	\$18,210
96'	\$7,650	\$15,300	\$7,850	\$15,700	\$8,045	\$16,090	\$8,245	\$16,490	\$8,445	\$16,890	\$8,640	\$17,280	\$8,850	\$17,700	\$9,060	\$18,120	\$9,235	\$18,470
98'	\$7,785	\$15,570	\$7,980	\$15,960	\$8,180	\$16,360	\$8,375	\$16,750	\$8,570	\$17,140	\$8,765	\$17,530	\$8,870	\$17,740	\$9,190	\$18,380	\$9,365	\$18,730
100'	\$7,910	\$15,820	\$8,115	\$16,230	\$8,310	\$16,620	\$8,510	\$17,020	\$8,705	\$17,410	\$8,905	\$17,810	\$9,125	\$18,250	\$9,325	\$18,650	\$9,500	\$19,000

Length	8' Tall		10' Tall		12' Tall		14' Tall		16' Tall		18' Tall		20' Tall		22' Tall		24' Tall	
	One side Closed	Both sides Closed	One side Closed	Both sides Closed	One side Closed	Both sides Closed	One side Closed	Both sides Closed	One side Closed	Both sides Closed	One side Closed	Both sides Closed	One side Closed	Both sides Closed	One side Closed	Both sides Closed	One side Closed	Both sides Closed
20'	\$725	\$1,450	\$805	\$1,610	\$1,122.50	\$2,245	\$1,360	\$2,720	\$1,600	\$3,200	\$1,837.50	\$3,675	\$2,075	\$4,150	\$2,315	\$4,630	\$2,555	\$5,110
24'	\$872.50	\$1,745	\$965	\$1,930	\$1,350	\$2,700	\$1,635	\$3,270	\$1,927.50	\$3,855	\$2,200	\$4,400	\$2,482.50	\$4,965	\$2,767.50	\$5,535	\$3,052.50	\$6,105
28'	\$1,017.50	\$2,035	\$1,127.50	\$2,255	\$1,570	\$3,140	\$1,905	\$3,810	\$2,235	\$4,470	\$2,570	\$5,140	\$2,900	\$5,800	\$3,235	\$6,470	\$3,567.50	\$7,135
32'	\$1,160	\$2,320	\$1,287.50	\$2,575	\$1,795	\$3,590	\$2,175	\$4,350	\$2,555	\$5,110	\$2,935	\$5,870	\$3,312.50	\$6,625	\$3,695	\$7,390	\$4,075	\$8,150
36'	\$1,305	\$2,610	\$1,350	\$2,700	\$2,020	\$4,040	\$2,450	\$4,900	\$2,875	\$5,750	\$3,287.50	\$6,575	\$3,712.50	\$7,425	\$4,137.50	\$8,275	\$4,565	\$9,130
40'	\$1,452	\$2,904	\$1,612.50	\$3,225	\$2,245	\$4,490	\$2,725	\$5,450	\$3,195	\$6,390	\$3,670	\$7,340	\$4,097.50	\$8,195	\$4,525	\$9,050	\$4,950	\$9,900
44'	\$1,600	\$3,200	\$1,772.50	\$3,545	\$2,470	\$4,940	\$2,950	\$5,900	\$3,515	\$7,030	\$4,037.50	\$8,075	\$4,560	\$9,120	\$5,082.50	\$10,165	\$5,605	\$11,210
48'	\$1,745	\$3,490	\$1,932.50	\$3,865	\$2,692.50	\$5,385	\$3,265	\$6,530	\$3,835	\$7,670	\$4,400	\$8,800	\$4,972.50	\$9,945	\$5,542.50	\$11,085	\$6,110	\$12,220
52'	\$1,887.50	\$3,775	\$2,092.50	\$4,185	\$2,917.50	\$5,835	\$3,535	\$7,070	\$4,155	\$8,310	\$4,772.50	\$9,545	\$5,390	\$10,780	\$6,010	\$12,020	\$6,632.50	\$13,265
56'	\$2,035	\$4,070	\$2,255	\$4,510	\$3,140	\$6,280	\$3,810	\$7,620	\$4,470	\$8,940	\$5,140	\$10,280	\$5,800	\$11,600	\$6,470	\$12,940	\$7,135	\$14,270
60'	\$2,177.50	\$4,355	\$2,415	\$4,830	\$3,365	\$6,730	\$4,080	\$8,160	\$4,790	\$9,580	\$5,505	\$11,010	\$6,212.50	\$12,425	\$6,930	\$13,860	\$7,642.50	\$15,285
80'	\$2,904	\$5,808	\$3,225	\$6,450	\$4,490	\$8,980	\$5,450	\$10,900	\$6,390	\$12,780	\$7,340	\$14,680	\$8,195	\$16,390	\$9,050	\$18,100	\$9,900	\$19,800
100'	\$3,632.50	\$7,265	\$3,632.50	\$8,050	\$5,610	\$11,220	\$6,800	\$13,600	\$7,990	\$15,980	\$9,172.50	\$18,345	\$11,552.50	\$20,725	\$11,552.50	\$23,105	\$12,742.50	\$25,485
120'	\$4,356	\$8,712	\$4,837.50	\$9,675	\$6,735	\$13,470	\$8,175	\$16,350	\$9,585	\$19,170	\$11,010	\$14,680	\$12,292.50	\$24,585	\$13,575	\$27,150	\$14,850	\$29,700
150'	\$5,520	\$11,040	\$6,117.50	\$12,235	\$8,527.50	\$17,055	\$10,335	\$20,670	\$12,145	\$24,290	\$13,945	\$27,890	\$15,752.50	\$31,005	\$17,562.50	\$35,125	\$19,375	\$38,750
200'	\$7,265	\$14,530	\$8,050	\$16,100	\$11,220	\$22,440	\$13,600	\$27,200	\$15,980	\$31,960	\$18,345	\$36,690	\$20,725	\$41,450	\$23,105	\$46,210	\$25,485	\$50,970
300'	\$10,897.50	\$21,795	\$12,075	\$24,150	\$16,830	\$33,660	\$20,400	\$40,800	\$23,970	\$47,940	\$27,517.50	\$55,035	\$31,087.50	\$62,175	\$34,657.50	\$69,315	\$38,227.50	\$76,455

All prices are subject to change without notice.

1-800-488-6903

alansfactoryoutlet.com

Options, accessories, and extras



VERTICAL TWO TONE - SIDES		
Length	One Side	Both Sides
20'	\$150	\$300
24'	\$175	\$350
28'	\$200	\$400
32'	\$225	\$450
36'	\$250	\$500
40'	\$275	\$550
44'	\$300	\$600
48'	\$325	\$650
52'	\$350	\$700
56'	\$400	\$800
60'	\$425	\$850
80'	\$675	\$1,100
100'	\$550	\$1,350
120'	\$825	\$1,650
150'	\$1,025	\$2,050
200'	\$1,350	\$2,700
300'	\$2,025	\$4,050

VERTICAL TWO TONE - ENDS		
Width	One End	Both Ends
62'	\$975	\$1,950
64'	\$1,000	\$2,000
66'	\$1,025	\$2,050
68'	\$1,050	\$2,100
70'	\$1,075	\$2,150
72'	\$2,000	\$4,000
74'	\$2,025	\$4,050
76'	\$2,050	\$4,100
78'	\$2,075	\$4,150
80'	\$2,100	\$4,200
82'	\$2,125	\$4,250
84'	\$2,150	\$4,300
86'	\$2,175	\$4,350
88'	\$2,200	\$4,400
90'	\$2,225	\$4,450
92'	\$2,250	\$4,500
94'	\$2,275	\$4,550
96'	\$2,300	\$4,600
98'	\$2,325	\$4,650
100'	\$2,350	\$4,700

EAVE HEIGHT								
Length	10' Tall	12' Tall	14' Tall	16' Tall	18' Tall	20' Tall	22' Tall	24' Tall
20'	\$750	\$1,515	\$2,685	\$4,285	\$5,880	\$6,635	\$7,385	\$8,140
24'	\$910	\$1,815	\$3,230	\$5,070	\$6,720	\$7,825	\$8,925	\$10,030
28'	\$1,060	\$2,120	\$3,765	\$5,845	\$7,560	\$8,950	\$10,345	\$11,735
32'	\$1,210	\$2,415	\$4,305	\$6,625	\$8,400	\$10,200	\$12,005	\$13,810
36'	\$1,365	\$2,725	\$4,840	\$7,410	\$9,240	\$11,395	\$13,545	\$15,700
40'	\$1,520	\$3,030	\$5,375	\$8,190	\$10,080	\$12,585	\$15,085	\$17,590
44'	\$1,665	\$3,325	\$5,915	\$8,970	\$10,920	\$13,765	\$16,610	\$19,450
48'	\$1,810	\$3,630	\$6,450	\$9,760	\$11,760	\$14,950	\$18,150	\$21,350
52'	\$1,970	\$3,930	\$7,000	\$10,535	\$12,600	\$16,150	\$19,690	\$23,230
56'	\$2,120	\$4,240	\$7,530	\$11,690	\$15,120	\$17,900	\$20,690	\$23,470
60'	\$2,270	\$4,535	\$8,070	\$12,470	\$15,960	\$19,150	\$22,350	\$25,545
80'	\$3,040	\$6,060	\$10,750	\$16,380	\$20,160	\$25,170	\$30,170	\$35,180
100'	\$3,780	\$7,560	\$13,450	\$20,295	\$24,360	\$31,100	\$37,840	\$44,580
120'	\$4,560	\$9,090	\$16,125	\$24,570	\$30,240	\$37,755	\$45,255	\$52,770
150'	\$5,750	\$11,490	\$20,450	\$30,830	\$36,960	\$47,250	\$57,530	\$67,810
200'	\$7,560	\$15,120	\$26,900	\$40,590	\$48,720	\$62,200	\$75,680	\$89,160
300'	\$11,340	\$22,680	\$40,350	\$60,885	\$73,080	\$93,300	\$113,520	\$133,740

SIDE OPENINGS UP TO 16'	
With Garage Door	\$750
Without Garage Door	\$1,250

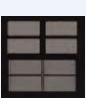
AUTOMATIC GARAGE DOOR OPENER	
10' Wide Doors AND Skinnier	\$1,100
12' Wide Doors AND Wider	\$1,200

WINDOWS			
30" x 30"		30" x 36"	
\$200	\$250	\$225	\$275
			

WALK-IN DOORS 36" x 80"			
Fiberglass Door		6 Steel Panel	
\$300	\$400	\$800	\$900
			

COLORED SCREWS	
Add 3% of Retail Cost Of Building	

Applies to buildings 8'-24' tall.

Color	UNCERTIFIED		CERTIFIED	
	Price	Size	Price	Size
White Only	\$500	6' x 6'	\$750	6' x 6'
	\$600	8' x 8'	\$800	8' x 8'
	\$650	9' x 8'	\$850	9' x 7'
	\$700	10' x 8'	\$950	9' x 8'
	\$800	10' x 10'	\$1,050	10' x 8'
	\$1,400	12' x 12'	\$1,900	10' x 10'
	\$2,100	14' x 14'	\$2,500	12' x 12'
	\$2,000	16' x 8'	\$2,300	16' x 8'
	\$2,500	16' x 16'	\$2,700	16' x 16'
	And More*			

*Please ask about our additional "premium" colored door options.



CLOSED GABLE PRICING		
Width Range	One Closed Gable	Both Gables Closed
62'-70'	\$1,050	\$2,100
72'-80'	\$1,200	\$2,400
82'-90'	\$1,350	\$2,700
92'-100'	\$1,500	\$3,000

- Side openings up to 16' wide can maintain the 150 mph wind / 30 psf snow rating.
- Openings over 16' wide and up to 20' wide may reduce the snow load rating to 20 psf.

! Available in 21 states, as long as local building code requirements do not exceed this product line's wind and snow load ratings.

Price Note

- Colored screws available.
- Site inspection must be required.
- Telescopic forklift must be provided by customer for installation process.

1



Enter Your Zip Code

Start your custom metal building journey by entering your zip code. This helps us verify availability and ensure accurate sales tax.

2

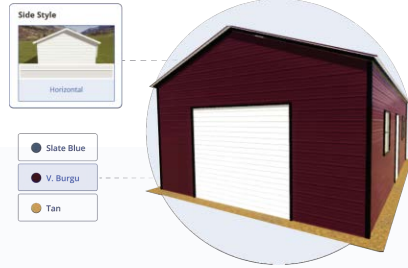

Customize Your Building

Use our 3D Builder to explore and choose every option for your perfect metal building.

3

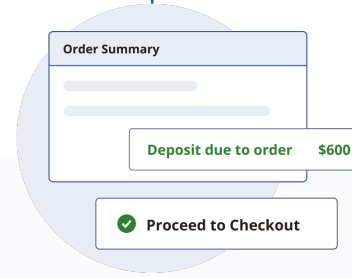

Order with a Small Deposit

Alan's Factory Outlet only requires a small deposit to place your order. Half of the remaining balance is due at fabrication, and the final balance is due at installation.

4



Delivery & Installation

Delivery time frames are estimates and may change. Freight fees apply, and winter storms may cause longer delivery times.

5



Guaranteed Satisfaction

100% satisfaction guaranteed. Alan's Factory Outlet has been providing factory direct prices for over 23 years.

Customize Your Own Metal Garage or Carport With Our 3D Builder

Easily design, price, and buy online—plus get professional installation.

- 📏 Select a size to meet your needs
- 🎨 Choose roof, side, and trim colors
- 🚪 Add garage doors, windows, and walk-in doors

[Customize Your Own](#)

